

U. S. Department of Labor

Mine Safety and Health Administration  
100 Bluestone Road  
Mount Hope, WV 25880-1000

*Denial*



MAR 30 2010

MAR 30 2010

Mr. Chris Blanchard  
President  
Performance Coal Company  
P.O. Box 69  
Naoma, WV 25140

Dear Mine Operator:

Subject: Gas Well Permit, Section 75.1700, 30 CFR 75, Upper Big Branch Mine-South, I.D. No. 46-08436, Performance Coal Company, Naoma, Raleigh County, West Virginia, Permit No. 17325-T13.

This will acknowledge receipt of the subject permit for mining through Gas Well No. 6A (API# 47-005-01423) located on the subject mine property. The permit is dated November, 23, 2009 as shown on Form OG-45 and was submitted to MSHA on February 9, 2010.

The permit cannot be approved as submitted. The plugging affidavit (WR-38) does not indicate that the casing was perforated and improperly plugged wells can allow methane gas to seep into the mine resulting in a fire or explosion.

Please refer to the comments marked on the attached copy of the permit included with this letter.

Should you have any questions concerning this matter, please contact the Ventilation Department at (304) 877-3900/Ext. 142.

Sincerely,

/s/ ROBERT G. HARDMAN

Robert G. Hardman  
District Manager  
Coal Mine Safety and Health, District 4

cc: Mt. Hope Field Office (3 incl.)  
Files/nlc

SUPERVISORY ACKNOWLEDGMENT

Initials *zm* 3/29/10



MAR 30 2010

Mr. Chris Blanchard  
President  
Performance Coal Company  
P.O. Box 69  
Naoma, WV 25140

Dear Mine Operator:

Subject: Gas Well Permit, Section 75.1700, 30 CFR 75, Upper Big Branch  
Mine-South, I.D. No. 46-08436, Performance Coal Company,  
Naoma, Raleigh County, West Virginia, Permit No. 17325-T13.

This will acknowledge receipt of the subject permit for mining through Gas Well No. 6A (API# 47-005-01423) located on the subject mine property. The permit is dated November, 23, 2009 as shown on Form OG-45 and was submitted to MSHA on February 9, 2010.

The permit cannot be approved as submitted. The plugging affidavit (WR-38) does not indicate that the casing was perforated and improperly plugged wells can allow methane gas to seep into the mine resulting in a fire or explosion.

Please refer to the comments marked on the attached copy of the permit included with this letter.

Should you have any questions concerning this matter, please contact the Ventilation Department at (304) 877-3900/Ext. 142.

Sincerely,

A handwritten signature in cursive script, reading "Robert G. Hardman", is positioned above the typed name.

Robert G. Hardman  
District Manager  
Coal Mine Safety and Health, District 4

STATE OF WEST VIRGINIA  
OFFICE OF MINERS' HEALTH, SAFETY & TRAINING  
1615 WASHINGTON ST. EAST  
CHARLESTON, WV 25311-2126

MSHA  
MOUNT HOPE, WV  
FEB 09 2010  
RECEIVED  
VENTILATION

PERMIT NUMBER: BOO-1139  
DATE: 02/05/2010

P E R M I T  
TO EXTEND MINE WORKINGS  
WITHIN THE 200 FOOT RADIUS OF OIL OR GAS WELLS

COMPANY: PERFORMANCE COAL CO.  
MINE: UBBMC MONTCOAL EAGLE MINE PERMIT NUMBER: U00304292  
SEAM: EAGLE  
DISTRICT: CROOK  
COUNTY: RALEIGH  
ADDRESS: P O BOX 69  
CITY: NAOMA, STATE: WV, ZIP: 25140

PERMISSION IS HEREBY GIVEN:

TO MINE INTO AND THROUGH THE NEW RIVER ENERGY CORP  
PLUGGED GAS WELL 6A LOCATED ON THE WESTERN POCA.  
CORP. FARM IN THE CROOK DISTRICT OF BOONE COUNTY  
AS SHOWN ON THE APPROVED ATTACHED MAP.

CONTIGENT UPON THE FOLLOWING:

1. MINING IS TO PERFORMED STRICTLY IN ACCORDANCE WITH THE MAP APPROVED BY THE DIVISION OF MINE HEALTH, SAFETY AND TRAINING HERETO.
2. A COPY OF THE PERMIT SHALL BE KEPT AT THE MINE.
3. THE PERMIT IS VOID UPON INSPECTOR'S RECOMMENDATION.
4. THE PERMIT IS NON-TRANSFERRABLE.

WELL OPERATOR: NEW RIVER ENERGY, INC.  
WELL OPERATOR WELL NUMBER: 6A  
MINE OPERATOR WELL NUMBER: 6A

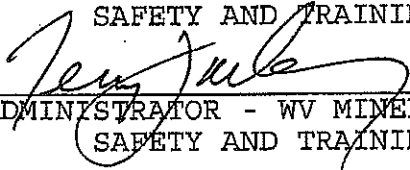
Ronald L. Wooten  
BY: \_\_\_\_\_  
DIRECTOR - WV MINERS' HEALTH,  
SAFETY AND TRAINING  
  
ADMINISTRATOR - WV MINERS' HEALTH,  
SAFETY AND TRAINING

CCS:  
NEW RIVER ENERGY, INC.  
REGION: 4  
M.S.H.A. District Office  
H.S. & T. File



Date: 11-23-2009  
Operator's Well Number: BA  
API Well No: 47 - 005-01423

STATE OF WEST VIRGINIA  
OFFICE OF MINERS' HEALTH, SAFETY & TRAINING  
1815 WASHINGTON ST., E.  
CHARLESTON, WV 25311-2126  
www.wvminesafety.org

COAL OPERATOR'S PETITION TO OPERATE  
WITHIN 200 FEET OR TO MINE THROUGH A WELL

Well Type: Oil / Gas X / Liquid Injection / Waste Disposal  
If Gas: Production / Underground Storage / Deep / Shallow

Location: Elevation 2138.657' Watershed: James Creek of West Fork  
District: Crook County: Boone Quadrangle: Whitesville

WELL OPERATOR: New River Energy, Inc AGENT: Mr. Timothy E. Comer  
Address: New River Energy, Inc Address: Mr. Timothy E. Comer  
125 Hurricane Branch Road 125 Hurricane Branch Road  
Chapmanville, WV 25608 Chapmanville, WV 25608

MSHA  
MOUNT HOPE, WV

FEB 09 2010

RECEIVED  
VENTILATION

Name of Person to Receive this permit:

Printed Name:

*Eric Lilly*

Eric Lilly

Email Address: eric.lilly@masseyenergyco.com

The Undersigned coal operator hereby petitions for approval to do the following

- Mine within 200 feet of said well
- Mine through said well when the same is properly plugged.

On the reverse side hereof is a copy of the map and plan of the undersigned coal operator showing its projected mine workings within 200 feet of said well.

The undersigned coal operator hereby represents that it will file update or new maps and plans with the Office of Miners' Health Safety and Training every six months, until mining within 200 feet of the well had ceased or until the well has been mined through.

Prior to the actual mining through of said well, the undersigned coal operator will submit the Form WR-35, "Well Operator's Report of Drilling, Fracturing, and/or Stimulating or Physical Change" and the Form WR-38, "Affidavit of Plugging and Filling Well", to show that the well has been properly plugged in a manner to permit safe mining through of the well.

Copies of this petition and enclosed maps and plans have been sent by registered mail to the well operator, as required by Code 22A-2-75

Performance Coal Company  
Coal Operator

By: *Eric Lilly* Printed Name: Eric Lilly  
Title: MINE ENGINEER Email: eric.lilly@masseyenergyco.com

STATE OF WEST VIRGINIA COUNTY OF RALEIGH TO WIT: DANNY L. ACORD II, being first duly sworn, deposes and says that he is MINE ENGINEER of the coal operator named above; that he is familiar with the facts set out both in the petition and on the accompanying maps and plans; and that the same are true. Subscribed and sworn before me this NOV 23 2009, Year 2009 My commission expires: OCTOBER, 22ND 2018

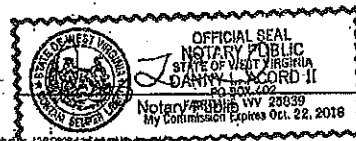

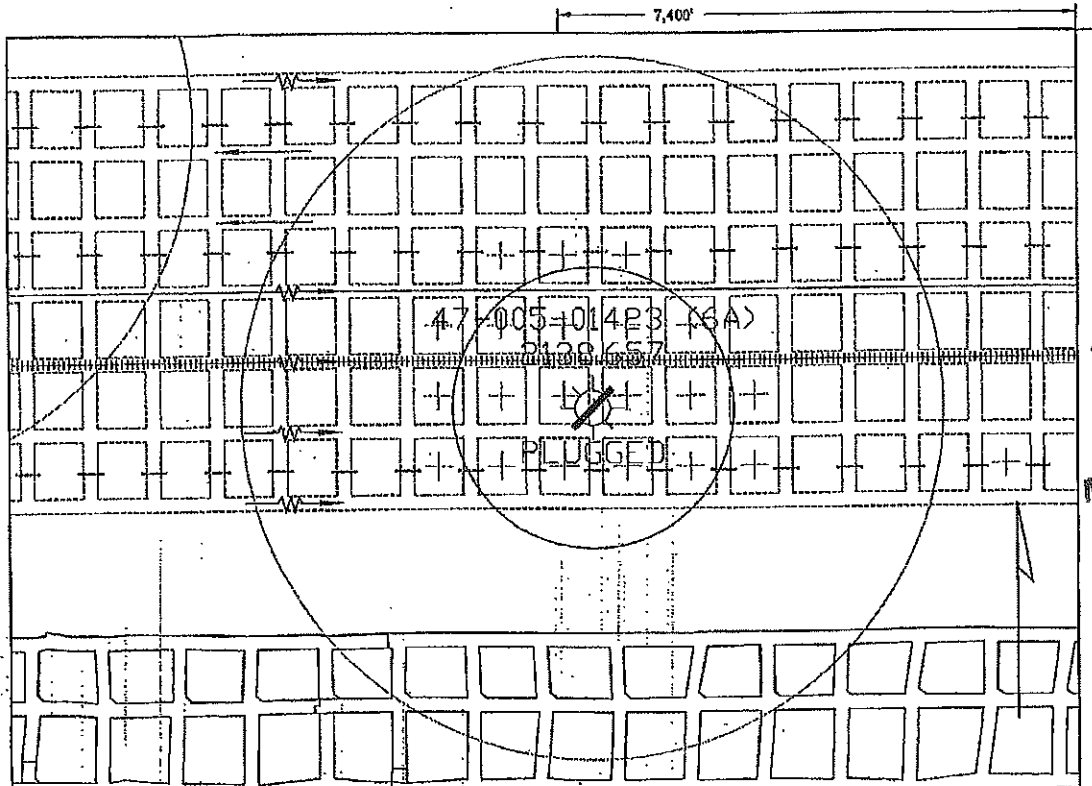

2-5-10  
 MSHA  
 MOUNT HOPE, WV  
 FEB 09 2010  
 RECEIVED  
 VENTILATION

<b>LEGEND</b>  PROJECTED ROOMS AND ENTRIES PROJECTED EXTRACTIONS NO SECOND MINING ROOMS AND ENTRIES PILLAR EXTRACTIONS TRACK BELT HEAD AND TAIL INTAKE AIR RETURN AIR MAIN FAN	File No. _____ Drawing No. _____ Scale 1"=200' Minimum degree of accuracy, 1: 700 MIN. USGS TOPO MAP LOCATION Denotes Whitesville Quad, United States Topographic Maps	 Registered Professional Engineer STATE OF WEST VIRGINIA No. 7613
	Signed <i>Raymond C. Branard</i> R.P.E. # 7613, I.L.S. _____	

Latitude: 37° 55' 12" Longitude: 81° 34' 00" Date: 11-23-2009

Coal Operator's Well No. 6A Operator's Well No. 6A  
 API Well No: 47 - 005 - 01423

West Virginia Permit No.: U-3042-92

**COAL OPERATOR'S PLAN TO EXTEND MINE WORKINGS  
 WITHIN 200 FEET OF A WELL**

COAL OPERATOR Performance Coal Company ELEVATIONS: Surface: 2138.657'  
 Address: Po Box 69 Naoma, WV 25140 Bottom of Coal: ± 990'  
 Difference: ± 1148.66'

MINE Upper Big Branch SECTION 4 Section OVERBURDEN Sandstone COAL SEAM Eagle  
 ROOF Shale BOTTOM Shale

Well Type: Oil \_\_\_\_\_ / Gas X / Liquid Injection \_\_\_\_\_ / Waste Disposal \_\_\_\_\_  
 (If Gas, Production X / Underground Storage \_\_\_\_\_ / Deep \_\_\_\_\_ / Shallow \_\_\_\_\_)

Location: Elevation: 2138.657' Watershed: James Creek of West Fork  
 District: Crook County: Boone Quadrangle: Whitesville  
 Farm Western Poca, Corp Tract ±2700 acres (Lease No. 3/195)

STATUS: Active \_\_\_\_\_ / Abandoned \_\_\_\_\_ / Drilling \_\_\_\_\_ / Plugged X  
 Date completed or abandoned: December 4th 1996  
 AMOUNT OF CASING IN WELL: 7" (2574'), 9.5/8" (1021'), & 16" (26')

MSHA  
MOUNT HOPE, WV

FEB 09 2010

RECEIVED  
VENTILATION

*Casing left  
in Annulus  
Hazard chg*

WR-38  
12-9-98

RECEIVED  
Office of Oil & Gas  
Permitting

STATE OF WEST VIRGINIA  
DIVISION OF ENVIRONMENTAL PROTECTION  
SECTION OF OIL AND GAS

JAN 21 1999

AFFIDAVIT OF PLUGGING AND FILLING WELL

WV Division of  
Environmental Protection

AFFIDAVIT SHOULD BE IN TRIPPLICATE, one copy mailed to the Division, one copy to be retained by the Well Operator and the third copy (and extra copies if required) should be mailed to each coal operator at their respective addresses.

Farm name: WESTERN POCAHONTAS PROPERTIES Operator Well No.:6A

LOCATION: Elevation: 2158' Quadrangle: WHITESVILLE  
District: CROOK County: BOONE  
Latitude: 2249' Feet South of 37 Deg. 57 Min. Sec.30  
Longitude: 1360 Feet West of 81 Deg. 32 Min. Sec.30

Well Type: OIL \_\_\_\_\_ Gas X

Company: Peake Energy, Inc. Coal Operator: Independence Coal Company, Inc.  
P. O. Box 8 or Owner: HC 78 Box 1800  
Ravenswood, WV 26164 Madison, WV 25130

Agent: Thomas S. Liberatore Coal Operator: Performance Coal Company, Inc.  
or Owner: P. O. Box 69  
Naomi, WV 25140

Permit Issued: 12/3/98

AFFIDAVIT

STATE OF WEST VIRGINIA,  
County of Boone ss:

*12-5-10*

Joe Petty and Ben Parson being first duly sworn according to law depose and say that they are experienced in the work of plugging and filling oil and gas wells and were employed by the above named well operator, and participated in the work of plugging and filling the above well, and R. Campbell Oil and Gas Inspector representing the Director, say that said work was commenced on the 4th day of Dec 19 98 and that the well was plugged and filled in the following manner:

TYPE	FROM	TO	PIPE REMOVED	LEFT
Class A	2872'	2472'	2800' (2-3/8" tubing)	
CIBP	1354'		2810' (4-1/2")	
RFC (Thixotropic)	1354'	954'		2674' (7")
Class A	320'	0		1021' (8-5/8")
				28' (16")

\* 8% GEL spaces between plugs

Description of monument: 6" X 4-1/2" with API No. Attached and that the work of plugging and filling said well was completed on the 9<sup>th</sup> day of December, 19 98

And further deponents saith not.

Sworn and subscribe before me this 14<sup>th</sup> day of December, 19 98

My commission expires: 10-2-2002

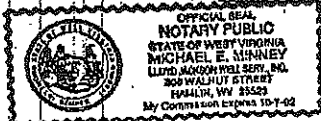

Oil and Gas Inspector:

Richard H. Campbell  
Notary Public

*Plugging affidavit  
does not indicate  
that the casing was  
regrouted and casing left  
in annulus is a hazard  
due to Methane*

MSHA  
MOUNT HOPE, WV  
FEB 09 2010  
RECEIVED  
VENTILATION

WR-38  
12-9-98

STATE OF WEST VIRGINIA  
DIVISION OF ENVIRONMENTAL PROTECTION  
SECTION OF OIL AND GAS

Office of Oil & Gas Permitting  
005-1423

JAN 21 1999

AFFIDAVIT OF PLUGGING AND FILLING WELL

WV Division of Environmental Protection

AFFIDAVIT SHOULD BE IN TRIPLICATE, one copy mailed to the Division, one copy to be retained by the Well Operator and the third copy (and extra copies if required) should be mailed to each coal operator at their respective addresses.

Farm name: WESTERN POCAHONTAS PROPERTIES Operator Well No.: 6A

LOCATION: Elevation: 2158' Quadrangle: WHITESVILLE  
District: CROOK County: BOONE  
Latitude: 2249 Feet South of 37 Deg. 57 Min. Sec. 30  
Longitude: 1350 Feet West of 81 Deg. 32 Min. Sec. 30

Well Type: OIL Gas X

Company: Peake Energy, Inc. Coal Operator Independence Coal Company, Inc.  
P. O. Box 8 or Owner HC 78 Box 1800  
Ravenswood, WV 26164 Madison, WV 25130

Agent: Thomas S. Liberatore Coal Operator Performance Coal Company, Inc.  
or Owner P. O. Box 60  
Naomi, WV 25140

Permit Issued: 12/3/98

AFFIDAVIT

STATE OF WEST VIRGINIA,  
County of BOONE ss:

Joe Petty and Ben Parson being first duly sworn according to law depose and say that they are experienced in the work of plugging and filling oil and gas wells and were employed by the above named well operator, and participated in the work of plugging and filling the above well, and R. Campbell Oil and Gas Inspector representing the Director, say that said work was commenced on the 4th day of Dec 19 98 and that the well was plugged and filled in the following following manner:

TYPE	FROM	TO	PIPE REMOVED	LEFT
Class A	2872'	2472'	2800' (2-3/8" tubing)	
CIBP	1354'		2810' (4-1/2")	
RFC (Thixotropic)	1354'	954'		2574' (7")
Class A	320'	0		1021' (9-5/8")
				26' (16")

\* 6% GEL spacers between plugs

Description of monument: 6' X 4-1/2" with API No. Attached and that the work of plugging and filling said well was completed on the 9th day of December, 19 98

And further deponents saith not.

Sworn and subscribe before me this 14th day of December, 19 98  
My commission expires: 10-2-2002

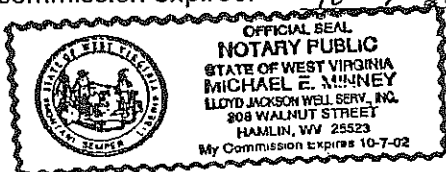

Oil and Gas Inspector:

Richard H. Campbell

Joe Petty  
Ben Parson  
Michael E. Minney  
Notary Public

# New River Energy Corporation



125 Hurricane Branch Road  
Chapmanville, WV 25508

304.855.4900  
Fax: 304.855.4100  
MOUNT HOPE, WV

February 4, 2010

FEB 09 2010

Mr. Terry L. Farley, Administrator  
WV Office of Miners' Health, Safety and Training  
1615 Washington Street East  
Charleston, WV 25311

RECEIVED  
VENTILATION

Re: Gas Well 047-005-01423-P (Eunice #6-A)

Dear Mr. Farley:

The subject well was plugged under my supervision in December, 1998. The plugging procedures used were designed to permit minethrough of the wellbore by surface mining methods in the upper seams and by deep mining methods in the Eagle seam.

It has been brought to my attention that the plugging affidavit filed with the WVDEP Office of Oil and Gas does not list the procedures performed to accommodate minethrough. I have enclosed a copy of the plugging procedure (dated October 5, 1998) that was used in the plugging of this well. I have also enclosed a sketch of the plugging procedure, along with a copy of the plugging affidavit.

If you have any questions, please do not hesitate to give me a call or contact me by email at [tim.comer@masseyenergyco.com](mailto:tim.comer@masseyenergyco.com).

Very truly yours,

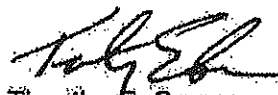
  
Timothy E. Comer  
President

*TJ* 2-5-10

/Enc.

Cc: Danny Acord (Performance Coal Co.)



MSHA  
MOUNT HOPE

FEB 09 2010

RECEIVED  
VENTILATION

FREDERKI DEVELOPMENT CORP.  
PRAIRIE #6A  
17605-1423  
PROPOSED PLUGGING PROCEDURE  
October 5, 1998

WELL DATA:

PERFORATIONS:

COAL: 1148' - 1154'

CASING:	20"	@ 28'
	9 3/8"	@ 1021'
	7"	@ 2373'
	4 1/2"	@ 2810'

1. Check T.D. Full 2-3/8" tubing.
2. Freepoint 4-1/2" casing, if free, load hole with 6% gel.
3. Set Class A cement plug from 2872' to 2472'. Displace with 6% gel and pull 4-1/2" casing.
4. Freepoint 7" casing, if free, shoot off at nearest collar. Pull 1 joint and spot 100' Class A cement plug across cut.
5. If not free, set CDM inside 7" casing at 1354'.
6. Perforate 7" casing with 1 shot per 10' from 1344' to 1154' and with 1 shot per foot from 1133' to 1146'.
7. Run 2-3/8" tubing to 1344' and pump plug from 1354' to 954' with thixotropic (RPC) cement. Displace with 6% gel.
8. Pull tubing to 300' and pump plug from 300' to surface with Class A cement. Displace with water.
9. Pull tubing. Top off hole.

Y 2-5-10

✓ BAC 12/02/98

MSHA  
MOUNT HOPE, WV

FEB 09 2010

RECEIVED  
VENTILATION

ELWICK 6-A API # 47-005-1423

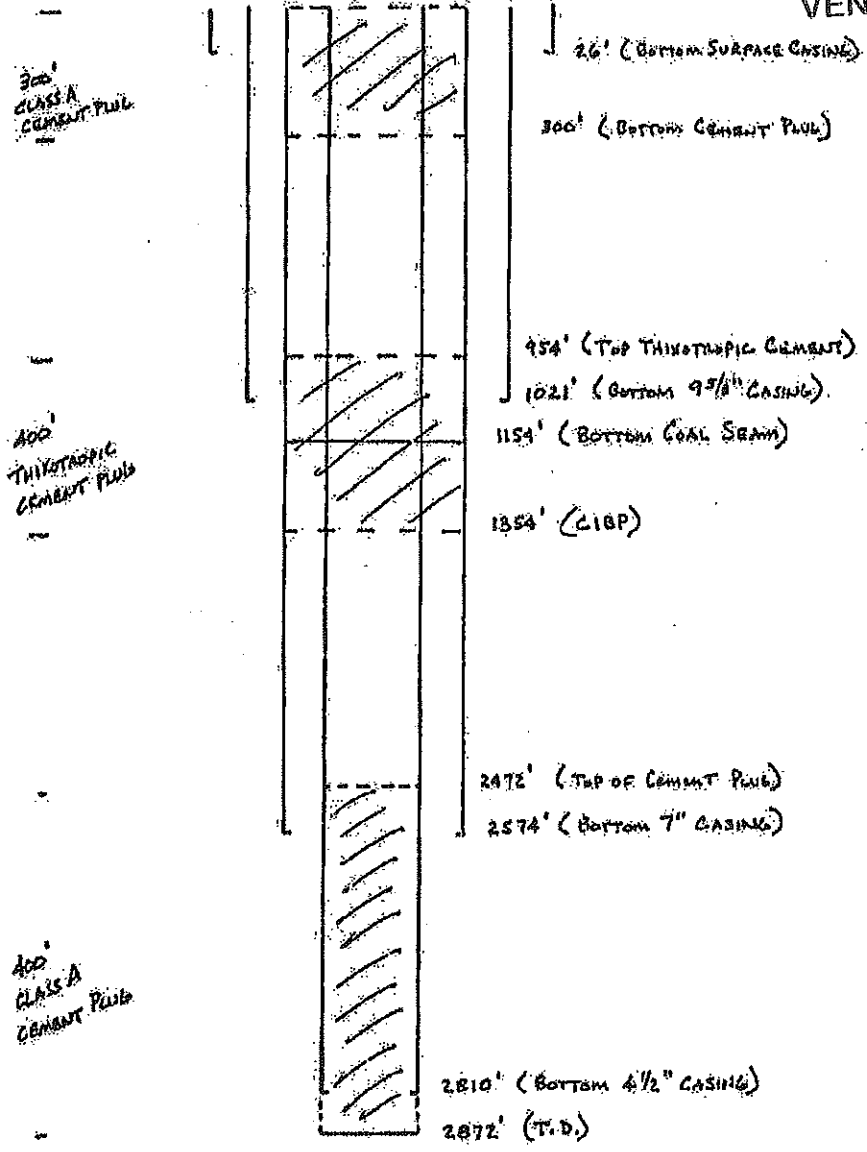

2-5-10

FEB 09 2010

RECEIVED

WR-38  
12-9-98

STATE OF WEST VIRGINIA  
DIVISION OF ENVIRONMENTAL PROTECTION  
SECTION OF OIL AND GAS

REGISTRATION NO. 005-1423  
Oil and Gas  
Permitting

JAN 21 1999

WV Division of  
Environmental Protection

AFFIDAVIT OF PLUGGING AND FILLING WELL

AFFIDAVIT SHOULD BE IN TRIPPLICATE, one copy mailed to the Division, one copy to be retained by the Well Operator and the third copy (and extra copies if required) should be mailed to each coal operator at their respective addresses.

Farm name: WESTERN POCAHONTAS PROPERTIES Operator Well No. 8A

LOCATION: Elevation: 2158' Quadrangle: WHITESVILLE  
District: CROOK County: BOONE  
Latitude: 2249 Feet South of 37 Deg. 57 Min. Sec. 30  
Longitude: 1350 Feet West of 81 Deg. 32 Min. Sec. 30

Well Type: OIL \_\_\_\_\_ Gas X

Company: Peake Energy, Inc. Coal Operator Independence Coal Company, Inc.  
P. O. Box 8 or Owner HC 78 Box 1800  
Ravenswood, WV 26184 Madison, WV 26130

Agent: Thomas S. Liberatore Coal Operator Performance Coal Company, Inc.  
or Owner P. O. Box 69  
Naomi, WV 26140

Permit Issued: 12/3/98

AFFIDAVIT

STATE OF WEST VIRGINIA,  
County of Boone ss:

Joe Petty and Don Parson being first duly sworn according to law depose and say that they are experienced in the work of plugging and filling oil and gas wells and were employed by the above named well operator, and participated in the work of plugging and filling the above well, and R. Campbell Oil and Gas Inspector representing the Director, say that said work was commenced on the 4th day of Dec 19 98 and that the well was plugged and filled in the following manner:

TYPE	FROM	TO	PIPE REMOVED	LEFT
Class A	2072'	2412'	2800' (2-3/8" tubing)	
CIBP	1354'		2810' (4-1/2")	
RFC (Thixotropic)	1354'	054'		2674' (7")
Class A	320'	0		1021' (9-5/8")
				20' (16")

\* 6% GEL spacers between plugs  
Description of monument: 6" X 4-1/2" with API No. Attached and that the work of plugging and filling said well was completed on the 9th day of December, 19 98

And further deponents each ratify and subscribe before me this 14th day of December, 19 98

Sworn and subscribe before me this  
My commission expires: 10-2-2002



Joe Petty  
Don Parson  
Richard S. Campbell  
Notary Public  
Oil and Gas Inspector.

800 1423

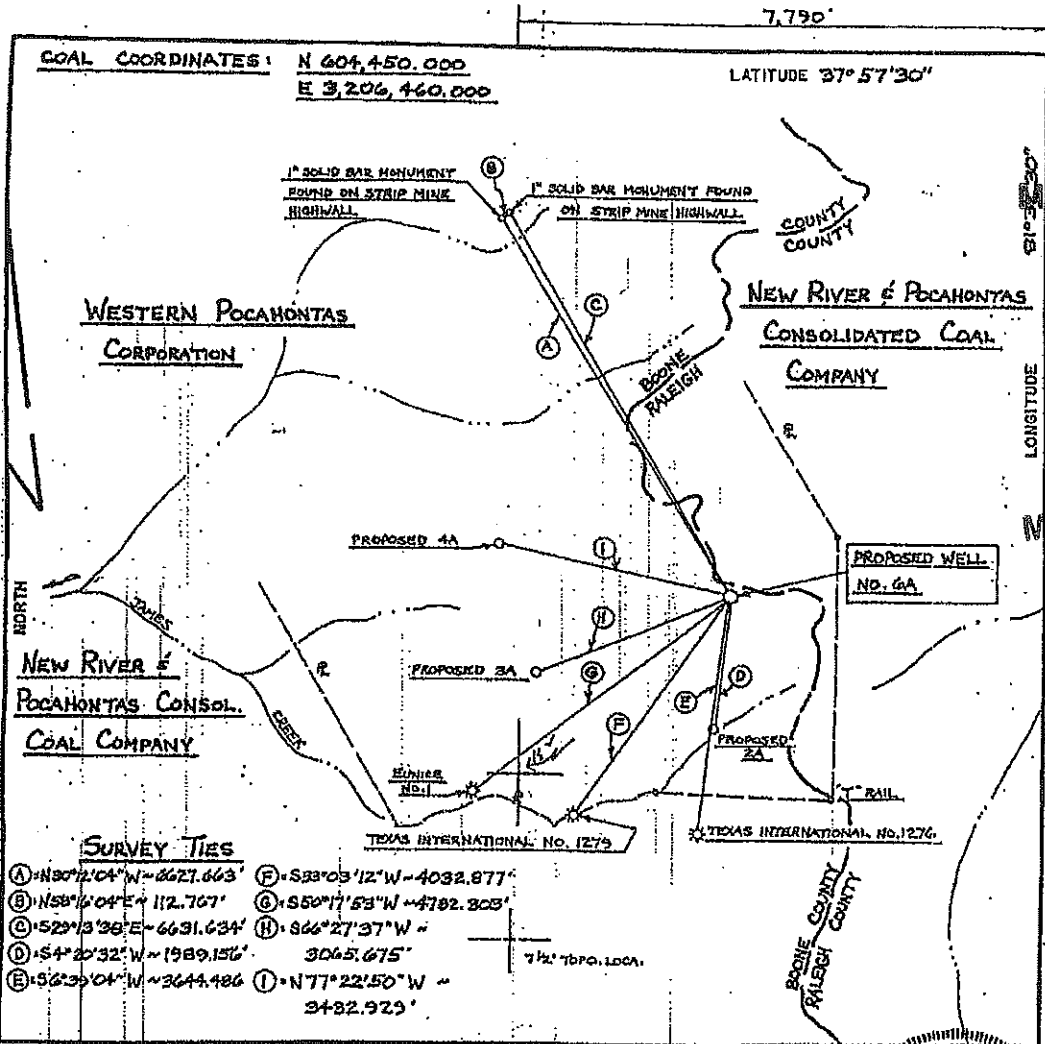

FILE NO. \_\_\_\_\_  
 DRAWING NO. \_\_\_\_\_  
 SCALE 1" = 2000'  
 MINIMUM DEGREE OF ACCURACY 1/10,000  
 PROVEN SOURCE OF ELEVATION 2249' - 1350' MIN OF LOCATION

I THE UNDERSIGNED, HEREBY CERTIFY THAT THIS PLAT IS CORRECT TO THE BEST OF MY KNOWLEDGE AND BELIEF AND SHOWS ALL THE INFORMATION REQUIRED BY LAW AND THE REGULATIONS ISSUED AND PRESCRIBED BY THE DEPARTMENT OF MINES.  
 (SIGNED) *Bryant W. Bowman*  
 R. P. E. \_\_\_\_\_ L. L. S. 736

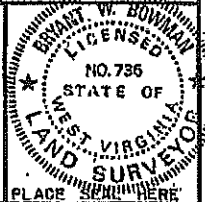

(+) DENOTES LOCATION OF WELL ON UNITED STATES TOPOGRAPHIC MAPS  
 FORM IV-6 (6-78)  
 Department of Mines  
 Oil & Gas Division  
 WELL TYPE: OIL \_\_\_\_\_ GAS  LIQUID INJECTION \_\_\_\_\_ WASTE DISPOSAL \_\_\_\_\_  
 (IF "GAS", PRODUCTION STORAGE DEEP \_\_\_\_\_ SHALLOW   
 LOCATION: ELEVATION 2150' WATER SHED JAMES CREEK OF WEST FORK  
 DISTRICT CROOK COUNTY BOONE  
 QUADRANGLE WHITESVILLE (7 1/2)  
 SURFACE OWNER WESTERN POCAHONTAS CORPORATION ACREAGE 2700±  
 OIL & GAS ROYALTY OWNER WESTERN POCAHONTAS CORPORATION LEASE ACREAGE 2700±  
 LEASE NO. 157/1795  
 PROPOSED WORK: DRILL  CONVERT \_\_\_\_\_ DRILL DEEPER \_\_\_\_\_ REDRILL \_\_\_\_\_ FRACTURE OR STIMULATE  PLUG OFF OLD FORMATION \_\_\_\_\_ PERFORATE NEW FORMATION \_\_\_\_\_ OTHER PHYSICAL CHANGE IN WELL (SPECIFY) \_\_\_\_\_  
 PLUG AND ABANDON \_\_\_\_\_ CLEAN OUT AND REPLUG \_\_\_\_\_  
 TARGET FORMATION WEIR ESTIMATED DEPTH 3800'  
 WELL OPERATOR PEAKE OPERATING CO. DESIGNATED AGENT FLOYD WILCOX  
 ADDRESS 423 CHAS. NATL. PLAZA ADDRESS 423 CHAS. NATL. PLAZA  
 CHARLESTON, W.VA. 25301 CHARLESTON, W.VA. 25301

DATE APRIL 8 1988  
 OPERATOR'S WELL NO. GA Permit  
 API WELL NO. (REVISED)  
 47-005-1423  
 STATE COUNTY PERMIT

MSHA MOUNT HOPE, WV  
 FEB 09 2010  
 RECEIVED VENTILATION  
 MSHA MOUNT HOPE, WV  
 FEB 09 2010  
 RECEIVED VENTILATION

800 1423

IV-35  
(Rev 8-81)

**RECEIVED**  
SEP 20 1984

OIL & GAS DIVISION  
DEPT. OF MINES



State of West Virginia  
Department of Mines  
Oil and Gas Division

Date 9/20/84  
Operator's  
Well No. FUNICE # 6-1  
Farm  
APT NO. 47 - 005 - 1025

WELL OPERATOR'S REPORT  
OF  
DRILLING, FRACTURING AND/OR STIMULATING, OR PHYSICAL CHANGE

WELL TYPE: Oil  / Gas  / Liquid Injection  / Waste Disposal   
(If "Gas," Production  / Underground Storage  / Deep  / Shallow )  
LOCATION: Elevation: 2158' Watershed JAMES CREEK OF Mt. Fern  
District: CROOK County BOONE Quadrangle VAHESVILLE

COMPANY PEAKE OPERATING CO.  
ADDRESS 423 CND, CHARLESTON, WV  
DESIGNATED AGENT FLOYD WIGGON  
ADDRESS SAME  
SURFACE OWNER WESTERN POLARONAS CORP.  
ADDRESS P.O. Box 2827, HUNTINGTON, WV  
MINERAL RIGHTS OWNER WESTERN POLARONAS  
ADDRESS P.O. Box 2827, HUNTINGTON, WV  
OIL AND GAS INSPECTOR FOR THIS WORK ARNOLD  
ST. CLAIR ADDRESS RENTON, WV  
PERMIT ISSUED 2-28-84  
DRILLING COMMENCED 7-14-84  
DRILLING COMPLETED 7-28-84  
IF APPLICABLE PLUGGING OF DRY HOLE OR CONTINUOUS PROGRESSION FROM DRILLING OR REWORKING. VERBAL PERMISSION OBTAINED ON NA

Casing Tubing Size	Used in Drilling	Left in Well	Cement Fill up Cu. ft.
20-16 Cond.		26'	3 SKS
13-10"			
9 5/8"		1021'	50 SKS
8 5/8"	(CEMENTED) ANNULUS		600 SKS
7"		2574'	200 SKS
5 1/2"			
4 1/2"		2870'	
3"			
2"			
Liners used			

GEOLOGICAL TARGET FORMATION DEVONIAN SHALE Depth 5360 feet  
Depth of completed well 2872 feet Rotary  / Cable Tools  
Water strata depth: Fresh          feet; Salt          feet  
Coal seam depths: 27, 330, 358, 371, 905' Is coal being mined in the area?         

OPEN FLOW DATA  
Producing formation MAXTON SAND Pay zone depth 2858-2870' feet  
Gas: Initial open flow 10,500 Mcf/d Oil: Initial open flow          Bbl/d  
Final open flow 4,200 Mcf/d Final open flow          Bbl/d  
Time of open flow between initial and final tests          hours  
Static rock pressure 600 psig (surface measurement) after 48 hours shut in  
(If applicable due to multiple completion--)  
Second producing formation          Pay zone depth          feet  
Gas: Initial open flow          Mcf/d Oil: Initial open flow          Bbl/d  
Final open flow          Mcf/d Oil: Final open flow          Bbl/d  
Time of open flow between initial and final tests          hours  
Static rock pressure          psig (surface measurement) after          hours shut in

(Continue on reverse side)

DETAILS OF PERFORATED INTERVALS, FRACTURING OR STIMULATING, PHYSICAL CHANGE, ETC.

315 DRILLED INTO GAS POCKET IN MARTON ZONE WELL WAS GAGED AT 10,500 MMCF AFTER FLOWING 4HR UNRESTRICTED.

WELL HAD TO BE KILLED WITH GELLED WATER IN ORDER TO REMOVE DRILL PIPE AFTER REMOVING DRILL PIPE, 4 1/2" CASING WAS RUN INTO HOLE. THEN HOLE WAS SWABBED.

WELL WAS FLOWING 4,500 MMCF AFTER SWABBING.

MSHA  
MOUNT HOPE, WV

FEB 09 2010

RECEIVED  
VENTILATION

WELL LOG

FORMATION	COLOR	HARD OR SOFT	TOP FEET	BOTTOM FEET	REMARKS Including indication of all fresh and salt water, coal, oil and gas
SAND & SHALE			0	1050	CONC SEAMS: 347'-056' 10" 350' 334' 10" 358' 304' 10" 371' 210' 10" 465' 471' 10"
SANDY SHALE			1000	1315	
SHALE			1315	1700	
SAND			1700	2023	
SHALE			2023	2043	
SAND			2043	2275	
SHALE			2275	2290	
SAND			2290	2320	DRILLED INTO GAS POCKET AT APPROX. 2270'
SANDY SHALE			2320	2472	GAGED AT 10,500 MMCF
SHALE			2472	2532	
SAND			2532	2570	
SANDY SHALE			2570	2675	
LEIMIE (AVIS) SAND			2675	2700	
SHALE			2700	2736	
SAND & SHALE			2736	2820	
SAND			2820	TD	
DTD - 2872			TEMPORARY TO AT 2870. IF GAS POCKET BLOWS DOWN WELL WILL BE DRILLED TO PERMITTED DEPTH.		

(Attach separate sheets as necessary)

PEAKE OPERATING CO.  
Well Operator  
By: David B. Wilson  
Date: Sept 19, 1984

Note: Regulation 2.02(i) provides as follows:  
"The term 'log' or 'well log' shall mean a systematic detailed geological record of all formations, including all, encountered in the drilling of a well."



# Performance Coal Company

November 24, 2009

Mr. Terry Farley  
WV Department of Environmental Protection  
Office of Miners Health Safety and Training  
1615 Washington Street, East  
Charleston, West Virginia 25311

Mr. Robert G. Hardman  
MSHA District 4  
100 Bluestone Road  
Mount Hope, West Virginia 25880

Mr. Timothy E. Comer  
New River Energy  
125 Hurricane Branch Road  
Chapmanville, WV 25508

RE: Performance Coal Company – Mine through of API 47-005-01423 (GW 6A)  
Upper Big Branch Mine  
MSHA ID: 46-08436  
State ID: U-3042-92

Dear Sir,

Performance Coal Company, Upper Big Branch Mine, is hereby requesting to mine through gas well API 47-005-01423 (GW 6A).

Enclosed in this request are the following

1. One copy of OG-45
2. One copy of the well record
3. One copy of WR-35
4. One copy of WR-38

If you have any question, or require further information, please call me at (304) 854-1761.

Respectfully submitted,  
Performance Coal Company

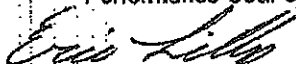
  
Performance Coal Company  
Eric Lilly, Mine Engineer



# Performance Coal Company

November 24, 2009

Mr. Terry Farley  
WV Department of Environmental Protection  
Office of Miners Health Safety and Training  
1615 Washington Street, East  
Charleston, West Virginia 25311

Mr. Robert G. Hardman  
MSHA District 4  
100 Bluestone Road  
Mount Hope, West Virginia 25880

Mr. Timothy E. Comer  
New River Energy  
125 Hurricane Branch Road  
Chapmanville, WV 25508

RE: Performance Coal Company – Mine through of API 47-005-01423 (GW 6A)  
Upper Big Branch Mine  
MSHA ID: 46-08436  
State ID: U-3042-92

Dear Sir,

Performance Coal Company, Upper Big Branch Mine, is hereby requesting to mine through gas well API 47-005-01423 (GW 6A).

Enclosed in this request are the following

1. One copy of OG-45
2. One copy of the well record
3. One copy of WR-35
4. One copy of WR-38

*MSHA  
COPY*

If you have any question, or require further information, please call me at (304) 854-1761.

Respectfully submitted,  
Performance Coal Company

Performance Coal Company  
Eric Lilly, Mine Engineer

MSHA  
MOUNT HOPE, WV

FEB 09 2010

RECEIVED  
VENTILATION